

INSTALLATION INSTRUCTIONS FOR PART NO. 2360P/2361P 2017 FORD SUPER DUTY F-250/F-350 REPLACEMENT

USING

6 - ½" x 2½" grade 8 bolts
12 - ½" x 2" grade 8 bolts
18 - ½" Nuts
18- ½" lock washer
36 - ½" flat washer

License plate bolts
2 - ¼" x ¾"
2 - ¼" Nuts
2 - ¼" lock washers
2 - ½" flat washers

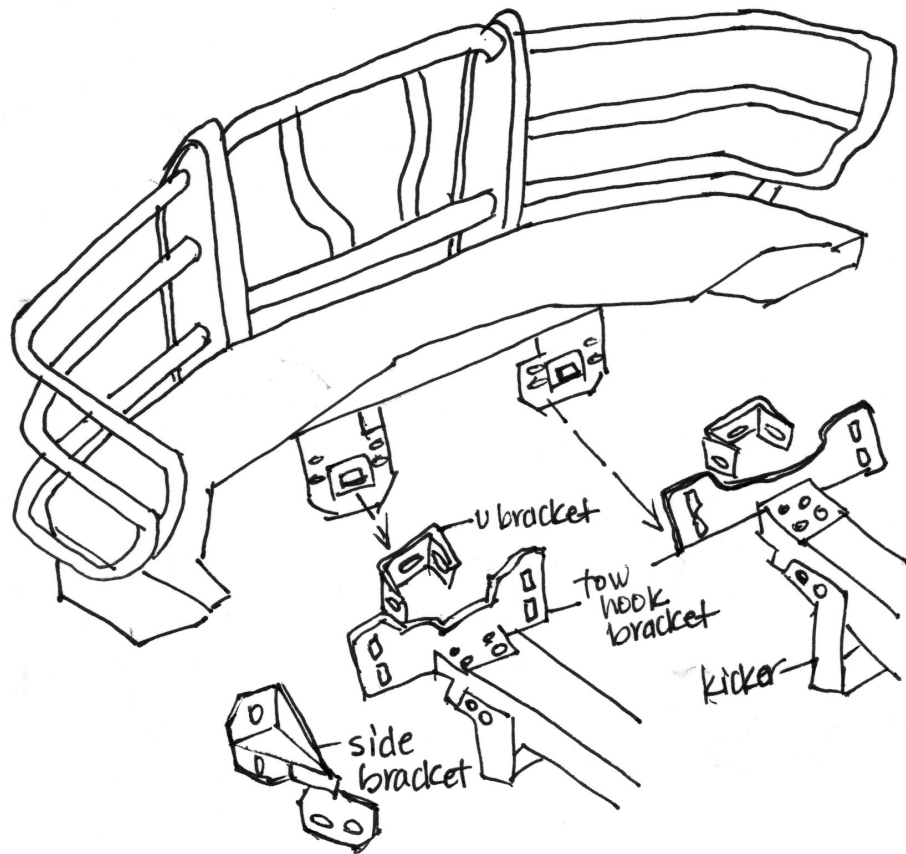

Step 1.- Remove plastic cover around tow hooks. Remove 4 front bolts on each side and remove 2 bolts on the bottom support of each side.

Step 2 – Remove factory bumper.

Step 3.- Remove bolts that support the factory kicker on each side.

Step 4.- Place U bracket on the front opening of the frame and place the side bracket on the outside of the frame. Hold factory kicker in place and bolt on with grade 8 bolts as shown.

Step 5.- Set replacement bumper in place, if replacement mounting plate does not sit flush, adjust the tow hook plate.

Step 6.- Check alignment on the replacement bumper and tighten bolts.

You may need to periodically re-tighten bolts.